

EAD certified system for NHBC compliant new build domestic showers and wet rooms

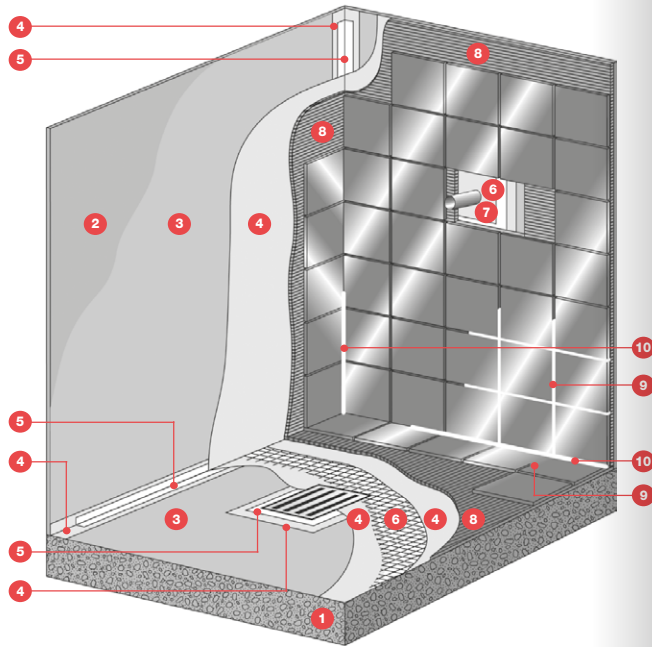

- 1 Recommended substrate
- 2 Plasterboard
- BAL WATERPROOF 1C watertight covering kit:
- 3 BAL PRIMER 1C
- 4 BAL WATERPROOF 1C
- 5 BAL WATERPROOF 1C TAPE
- 6 BAL WATERPROOF 1C MATTING
- 7 BAL UNIVERSAL ADHESIVE & SEALANT

- Suggested products for subsequent tiling:*
- 8 Approved BAL Adhesive
 - 9 Suitable BAL Grout
 - 10 Suitable BAL Sealant

Wall AND Floor tiles MUST be fixed with an EAD system approved BAL tile adhesive:
 BAL SPF S1
 BAL Flex One
 BAL Flex Fibre Plus
 BAL Rapid XP Plus
 BAL Rapid-Flex One
 BAL Rapid-Flex Fibre Plus

Suitable BAL Grouts:
 BAL Grout Flex
 BAL Micromax3 ECO

Any shower tray or other areas requiring sealant, should be sealed with BAL Universal Adhesive & Sealant

Application Instructions

(EAD certified system for NHBC compliant new build domestic showers and wet rooms)

- 1 If required prime porous surfaces with **BAL Primer 1C** – only required on plaster and cement boards. Allow to dry for 15 minutes.
- 2 Reinforce corners, cracks and junctions with **BAL Waterproof 1C Tape**. Apply a 1st coat of **BAL Waterproof 1C** into the corners and apply the tape. Then apply a 2nd coat on top to at least 50mm either side of the corner or junction, ensuring there are no wrinkles in the tape.
 – If installing a shower tray, apply a self-adhesive tape to protect the shower base, leaving a small gap where the tile will sit. Cut **BAL Waterproof 1C Tape** the length of the shower tray and internal vertical angle. Apply a coat of **BAL Waterproof 1C** to the area and at least 50mm on the wall adjoining the tray. Push in the pre-cut tape and immediately apply a 2nd coat of **BAL Waterproof 1C**.
- 3 Reinforce pipework with **BAL Universal Adhesive & Sealant**, then use **BAL Waterproof 1C Matting** to cut a 150mm wide square to produce a tight-fitting collar around the pipe. Apply **BAL Waterproof 1C** around the pipe and push the tape around the pipe into the paste, before applying a 2nd coat.
- 4 Wet Room Floors (no tray): Apply **BAL Waterproof 1C** to the floor at a wet bed depth of 1mm (0.8mm dry) using a suitable 4mm notched trowel, roller or brush. Bed the **BAL Waterproof 1C Matting** into the 1st coat using a steel float to ensure the coating penetrates evenly throughout the matting. Ensure there are no wrinkles.
- 5 For drainage channels, cut the **Matting** to ensure that it is dressed into the drainage channel to a depth of at least 50mm around all of the channel. Apply **BAL Waterproof 1C** to at least 50mm into the channel and bed the **Matting** into the 1st coat, ensuring that the coating penetrates the **Matting** as before.
- 6 Now apply a 2nd coat of **BAL Waterproof 1C** to the entire floor, also to a minimum wet thickness of 1.0mm (0.8mm dry thickness), applied at right angles to the 1st coat.
- 7 Using a suitable 4mm notched trowel, roller or brush, apply an even coat of **BAL Waterproof 1C** to the walls. This coat must be free from pinholes – apply a 2nd coat if required.
- 8 Allow the wall and floor membranes to dry for at least 2 hours before tiling with an approved BAL tile adhesive. Thicker bed depths of **BAL Waterproof 1C** may require longer drying times.
 NOTE: Always apply each coat of **BAL Waterproof 1C** to a 1mm wet thickness (0.8mm dry)

For full certified technical instructions and an application video visit:



You're installing value

BAL provides multiple award-winning products, industry-firsts and trademarked technologies. This means BAL products provide better, long-lasting results for clients – with easier, more efficient and faster installations for you. More than that – when you install BAL, you are also installing as part of our team. Call for leading technical guidance, project support and the latest industry standards. Get nationwide technical support in-the-field with free training, site-tests and immediate problem-solving and advice. Then, relax. Your work is guaranteed with a 25-year BAL warranty – now just cash-in through GivBax Rewards.

You're not just installing the BAL product in the bag or bucket – but everything else that BAL provides too.

Full System Solution

Whatever the project, BAL can provide a full system for tiling including:

- Waterproofing
- Levelling
- Preparation – including uncoupling
- Adhesives
- Grouts
- Sealants
- External Tiling Systems

25 Year Guarantee

BAL products won't let you down. That is why all our products come with a market-leading 25-year written guarantee. From start to finish BAL is guaranteed to deliver perfect results.



Scan me to also find out about our market-leading colour matched grouts and request a grout case.

BAL7000125



ETA-24/1129
 Compliant with NHBC requirements for tanking

Waterproof 1C

The fastest, easiest, one-coat ready-mixed waterproofer – with EAD certification.

You're installing peace of mind.



bal-adhesives.com

 @BALtiling



bal-adhesives.com

 @BALtiling



You're installing peace of mind.



NHBC compliant EAD certified system



BAL Waterproof 1C is an easy and cost-effective waterproofing product – protecting showers, bathrooms and wet rooms from water ingress and the smells, damage and breakdown that can then affect the area and adjoining rooms.

While tiles are inherently waterproof, adhesive and grout won't prevent water from travelling through to backgrounds, potentially resulting in black mould or even total installation failure.

BAL Waterproof 1C provides a total one-coat protection against water damage and offers a host of benefits including:

- ✓ Ready-mixed – use straight from the bucket
- ✓ One-coat application on walls
- ✓ Can be used without priming
- ✓ Crack bridging up to 3mm without tape
- ✓ Tile on after 2 hours for fast-track completion
- ✓ Easy to apply with brush, roller or 4mm notched trowel
- ✓ High Yield up to 6m² – perfect coverage for a shower
- ✓ Suitable for domestic and commercial refurb and new builds
- ✓ Sustainable with low VOC with 40% recycled materials

From January 1st 2025, NHBC the UK's leading provider of warranty and insurance for new homes in the UK will implement new requirements for their members.

This will mean that any new house in the UK that is built (foundations laid from 1st January 2025) will require tiling in wet areas to be tanked with an EAD certified system to receive warranty and insurance, if they are tiling:

1. Shower over bath OR shower with shower tray, with standard flow rate <12 litres/min – WHEN the substrate manufacturer's guidance advises a tanking system is still required, or the substrate has not passed NHBC Table 2 assessment requirements.
2. ANY shower over bath OR shower with shower tray, with a flow rate >12 litres/min.
3. ANY wet room (fully tiled wall and floor, shower area)

BAL Waterproof 1C is part of an approved EAD system suitable for use with NHBC regulations. While in non-NHBC installations it follows the usual installation process for domestic refurb and commercial installations – for NHBC compliant installations, in some areas such as around pipework, junctions and drains, and where tiling direct to wetroom floors – some additional ancillaries and steps are required including the use of:

- **BAL Waterproof 1C Tape**
- **BAL Waterproof 1C Matting**
- **BAL Universal Adhesive & Sealant**
- **BAL Primer 1C** on certain porous backgrounds

EAD certification also requires the use of specific approved tile adhesives with each approved EAD waterproofing system. BAL has multiple options from our existing core range of adhesives that can be used with BAL Waterproof 1C.

Full protection for showers, bathrooms and wet rooms for domestic refurb and commercial installations

For non-EAD installations, only one coat is required on walls, no requirement for primer (unless installing on porous backgrounds i.e. plaster and tile backerboards) and no need to use additional tapes or matting.

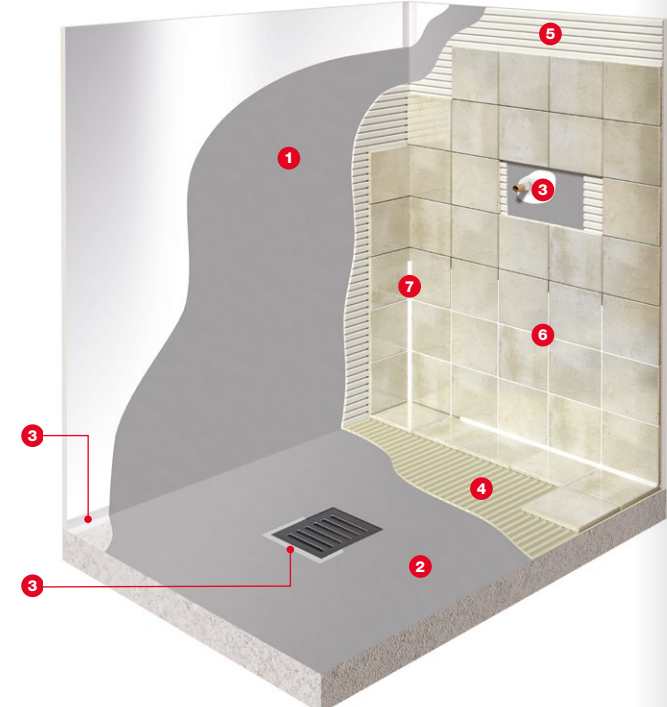

- 1 BAL WATERPROOF 1C at 0.8mm thick (one coat needed)
- 2 BAL WATERPROOF 1C at 1.6mm thick (it is recommended to have two coats on the floor to ensure the required thickness)
- 3 BAL SCRIM TAPE
- 4 Suitable BAL floor tile adhesive
- 5 Suitable BAL wall tile adhesive
- 6 Suitable BAL grout
- 7 Suitable BAL sealant

- | | | |
|--|--|---|
| <p>Wall tiles should be fixed with a suitable BAL tile adhesive, including:</p> <ul style="list-style-type: none"> BAL White Star Plus BAL Flex One BAL Flex Fibre Plus BAL Rapid XP Plus BAL Rapid-Flex One BAL Rapid-Flex Fibre Plus | <p>Floor tiles should be fixed with a suitable BAL tile adhesive, including:</p> <ul style="list-style-type: none"> BAL Flex One BAL Flex Fibre Plus BAL Rapid XP Plus BAL Rapid-Flex One BAL Rapid-Flex Fibre Plus BAL Pourable One | <p>Suitable BAL grouts include:</p> <ul style="list-style-type: none"> BAL Micromax3 ECO BAL Grout Flex BAL Grout Flex Wide Joint <p>Recommended BAL sealants include:</p> <ul style="list-style-type: none"> BAL Micromax Grout-Effect Sealant or BAL Silicone |
|--|--|---|

Application Instructions

(Showers, bathrooms and wet rooms for domestic refurb and commercial installations)

1 BAL Waterproof 1C can be applied without priming onto plasterboard, cement: sand render, screeds, concrete, plywood overlays, **BAL Board** on the smooth side and **BAL Rapid-Mat**.

If waterproofing onto plaster, cement boards, **BAL Board** on the tiling side, prime all surfaces with one coat of neat **BAL Primer 1C** and allow to dry for 15-30mins.

2 Before applying **BAL Waterproof 1C**, use the self-adhesive **BAL Scrim Tape** at:

- Internal and external corners of walls/partitions.
- Wall junctions with base/upstands/columns.
- At pipe penetration points/drainage channels/outlets.
- Junctions of different base/background materials.
- Cracks and board joints in backgrounds over 3mm wide.

3 Using a suitable roller, 4mm notched trowel or brush, apply **BAL Waterproof 1C** over the whole area, including the **BAL Scrim Tape**.

4 Wall: Using a roller, 4mm notched trowel or brush, apply one coat of **BAL Waterproof 1C** to walls but ensuring a min. 0.8mm thickness.

5 Floor: Apply **BAL Waterproof 1C** to the floor at a min. 1.6mm thickness. NOTE: two coats may be required to achieve the thickness. It is recommended to use two coats to ensure the required thickness.

Allow membrane to dry for a minimum of 2 hours before tiling with a suitable BAL tile adhesive.



Find out more